

FORM No. 1.

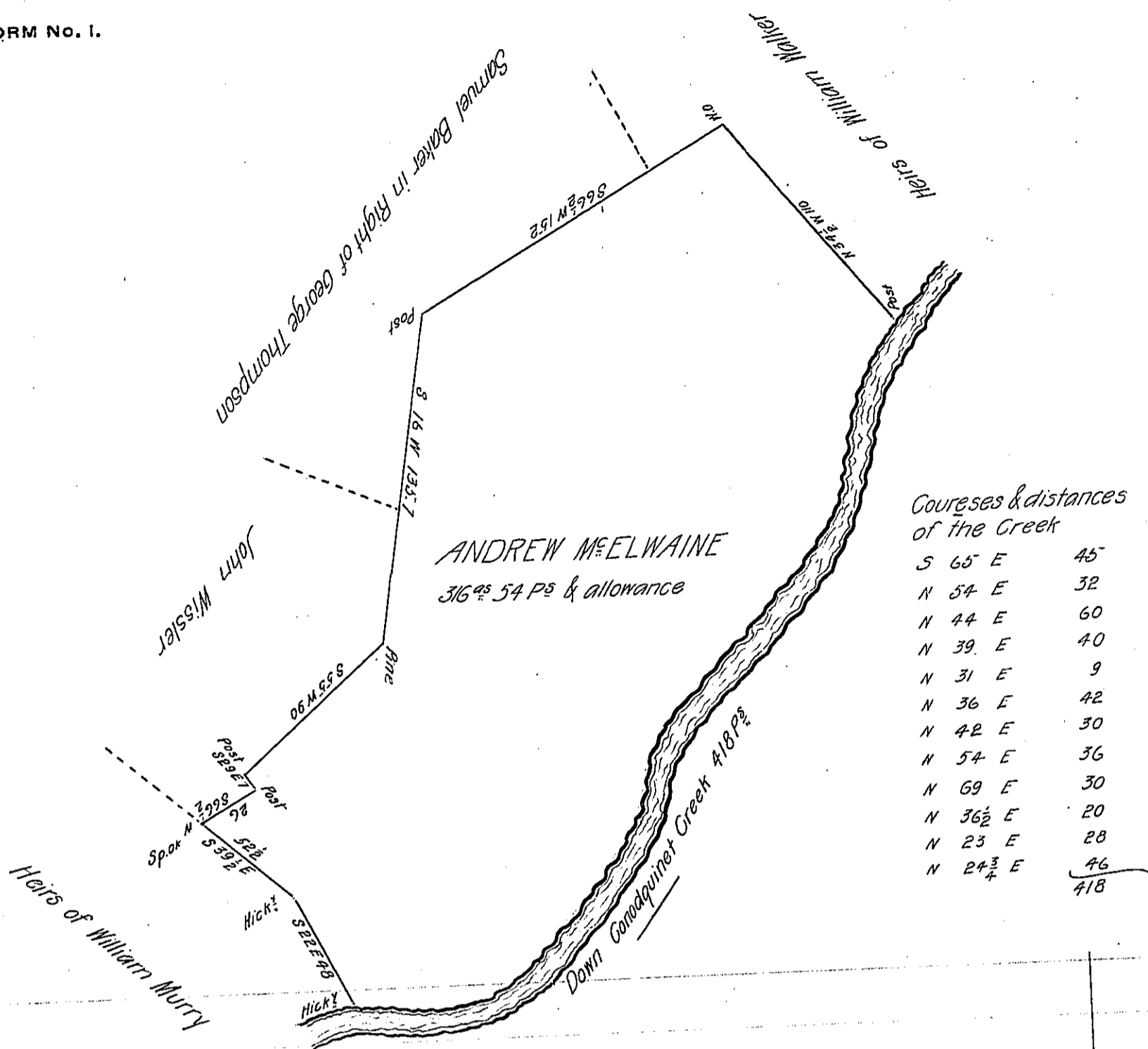

The draft of a tract of land Situate in Mifflin formerly Hopewell township
 Cumberland County. Containing 316⁹/₁₆ 5⁴/₄ perches and allowance.
 Resurveyed March 30th 1820. Originally Surveyed on a Warrent granted Andrew
 McElwaine dated the 12th November 1748.

Robt Clark. D.S.

To Jacob Spangler Esquire
 Surveyor General.

IN TESTIMONY that the above is a copy of the original remaining on file in
 the Department of Internal Affairs of Pennsylvania, made
 conformably to an Act of Assembly approved the 16th day of
 February, 1833, I have hereunto set my Hand and caused
 the Seal of said Department to be affixed at Harrisburg,
 this second day of March 1906

James N. Brown
 Secretary of Internal Affairs.